

West Sussex N Gauge MRC

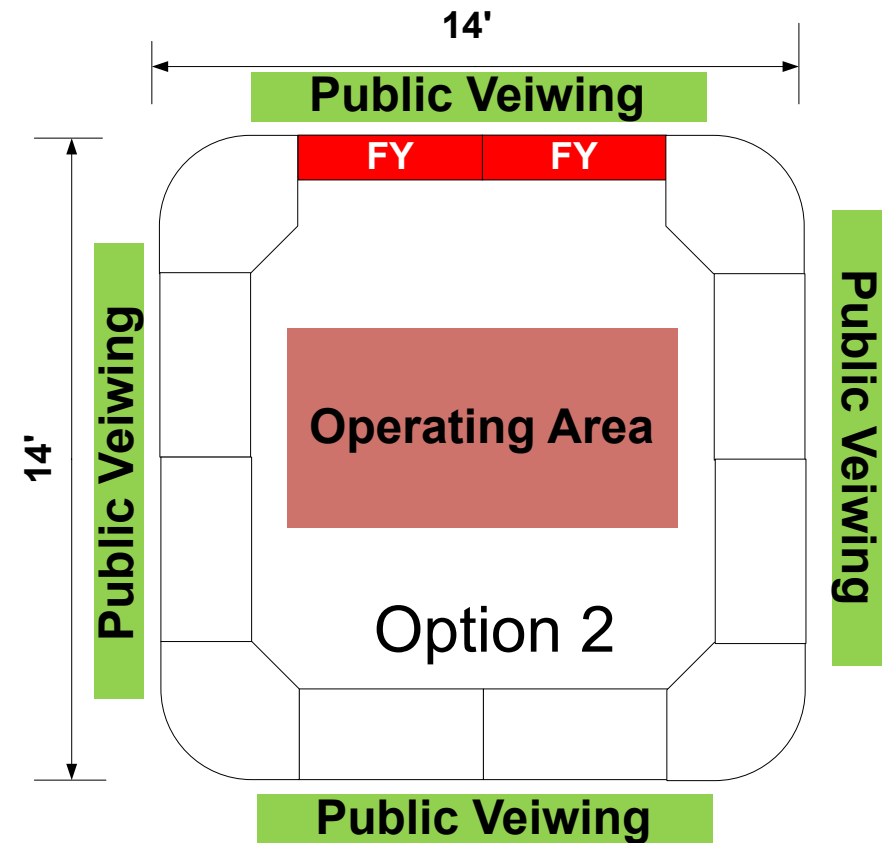

Please Note that all these layout **OPTIONS** can be made to suit the space you have available. The round layouts are viewed on all sides if possible, but we can be viewed on three sides if space is limited. If that is the case I would like to know in advance, so that we do not have any members board not facing the public.

West Sussex N Gauge MRC

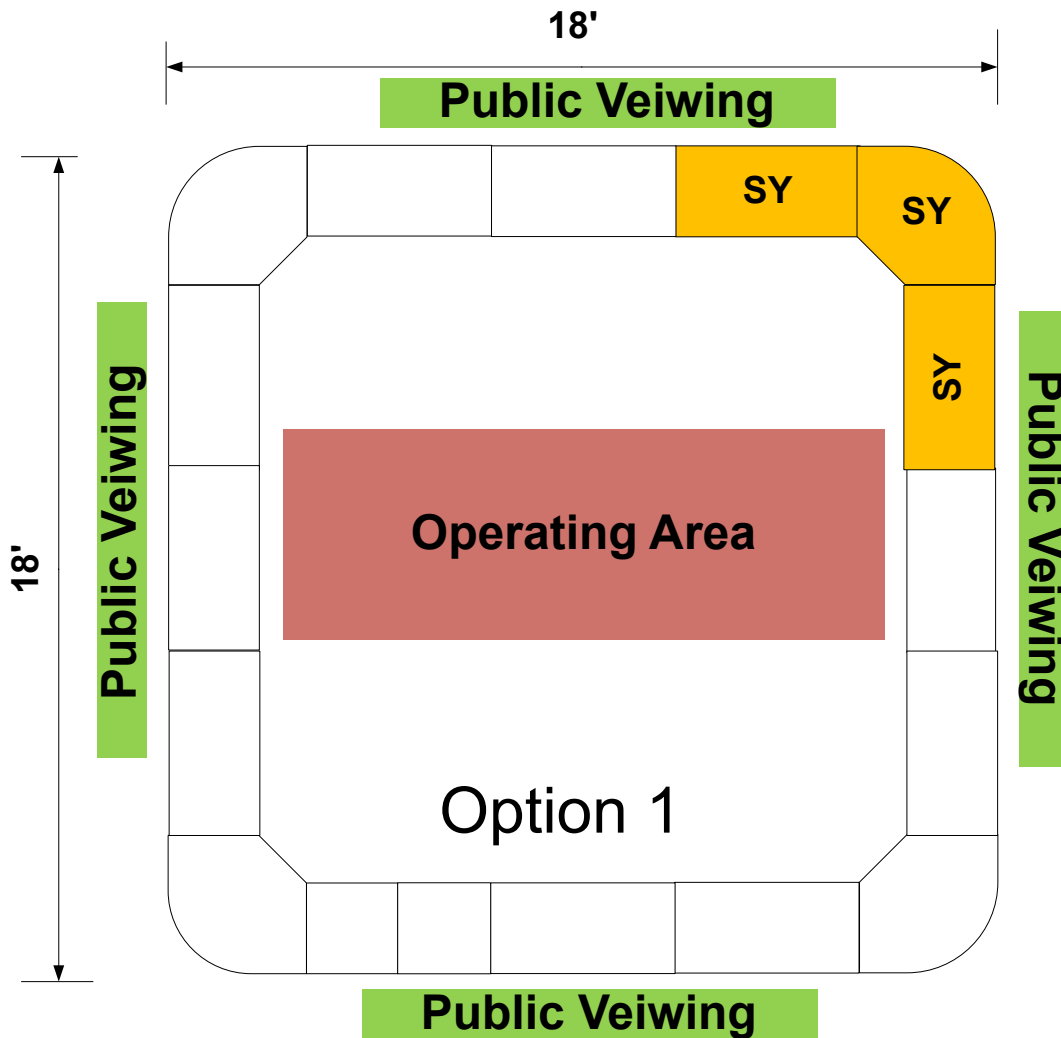
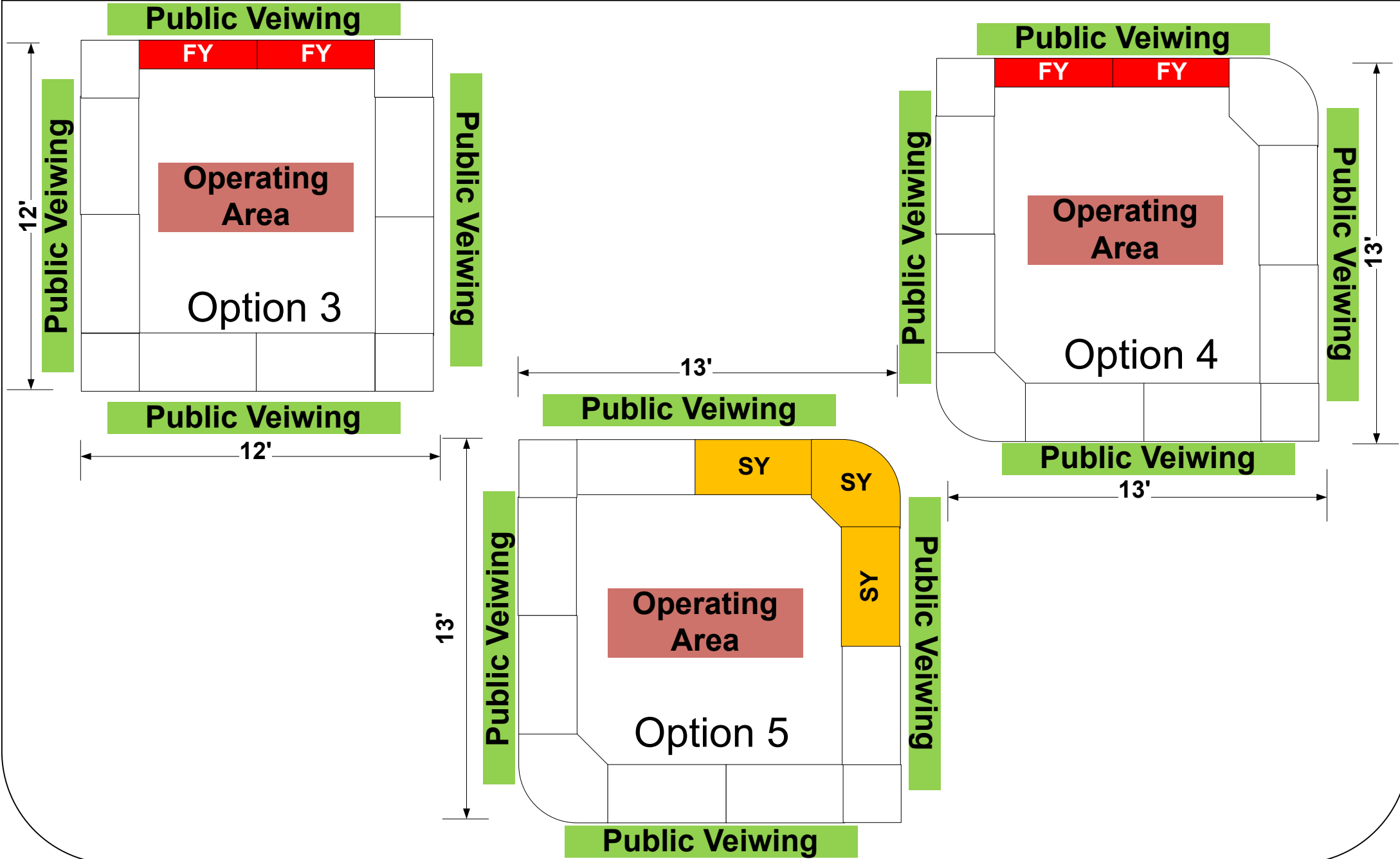

West Sussex N Gauge MRC



Option 6

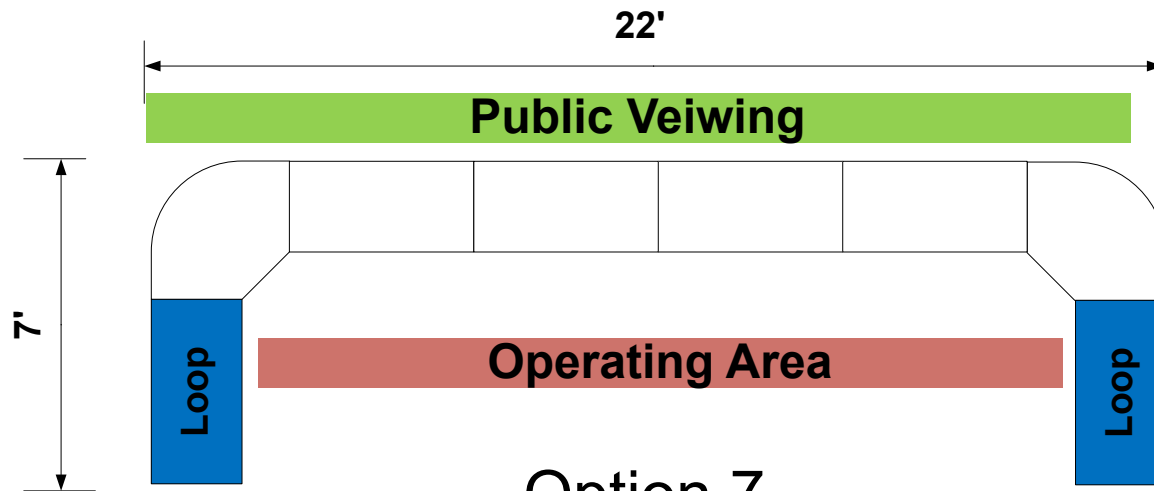
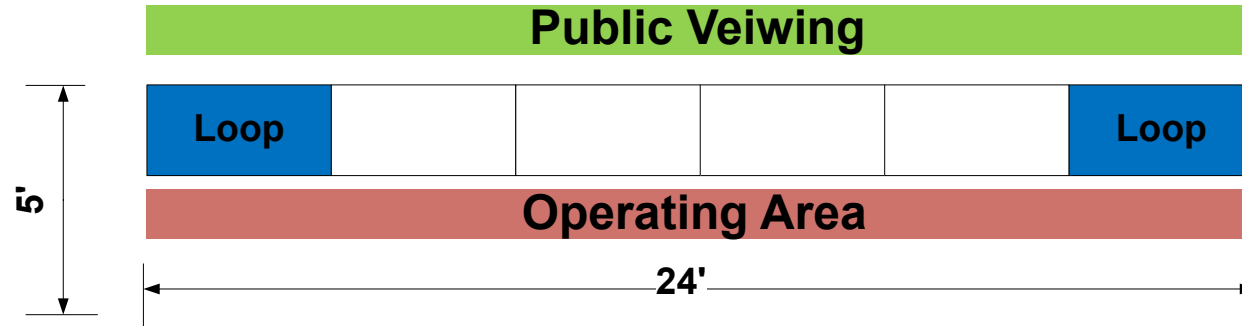

Option 7

West Sussex N Gauge MRC



22'

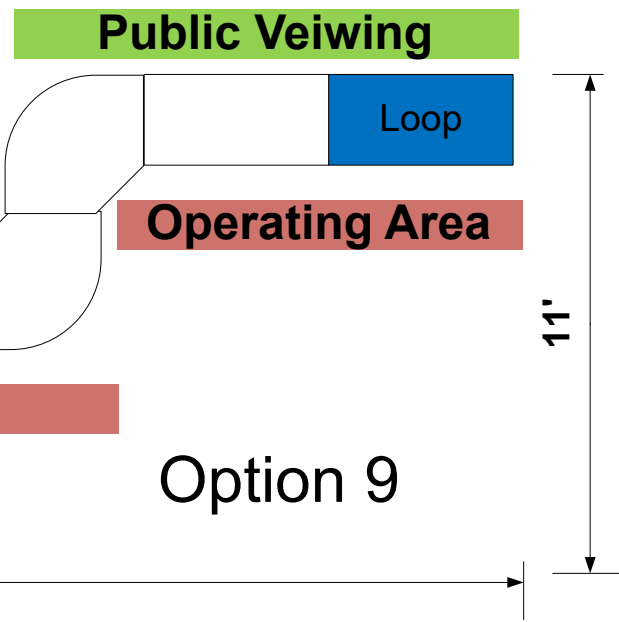
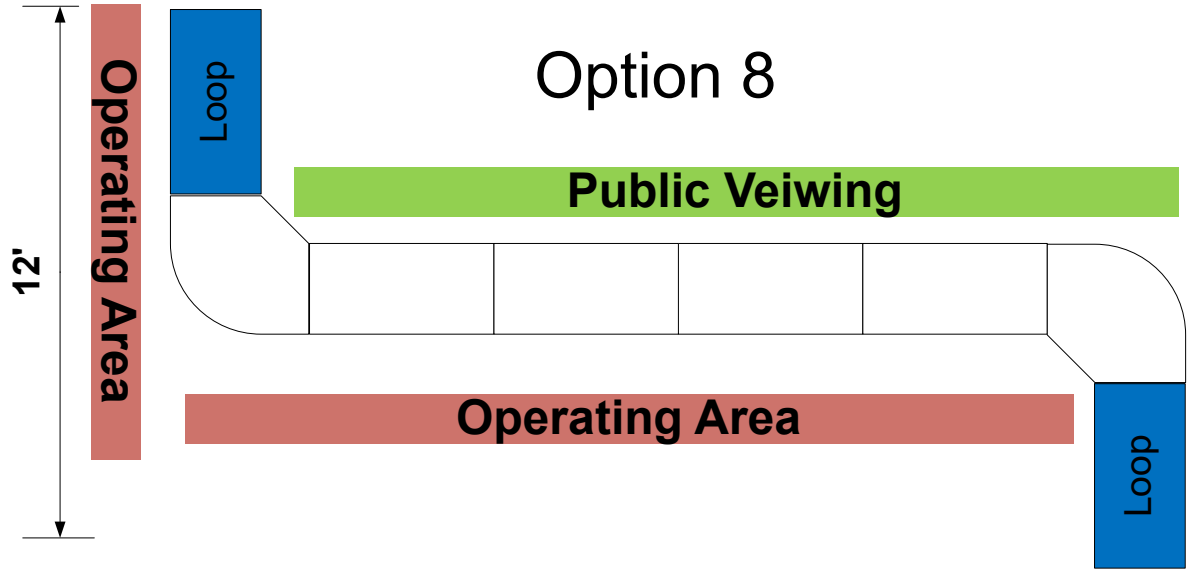

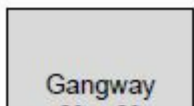
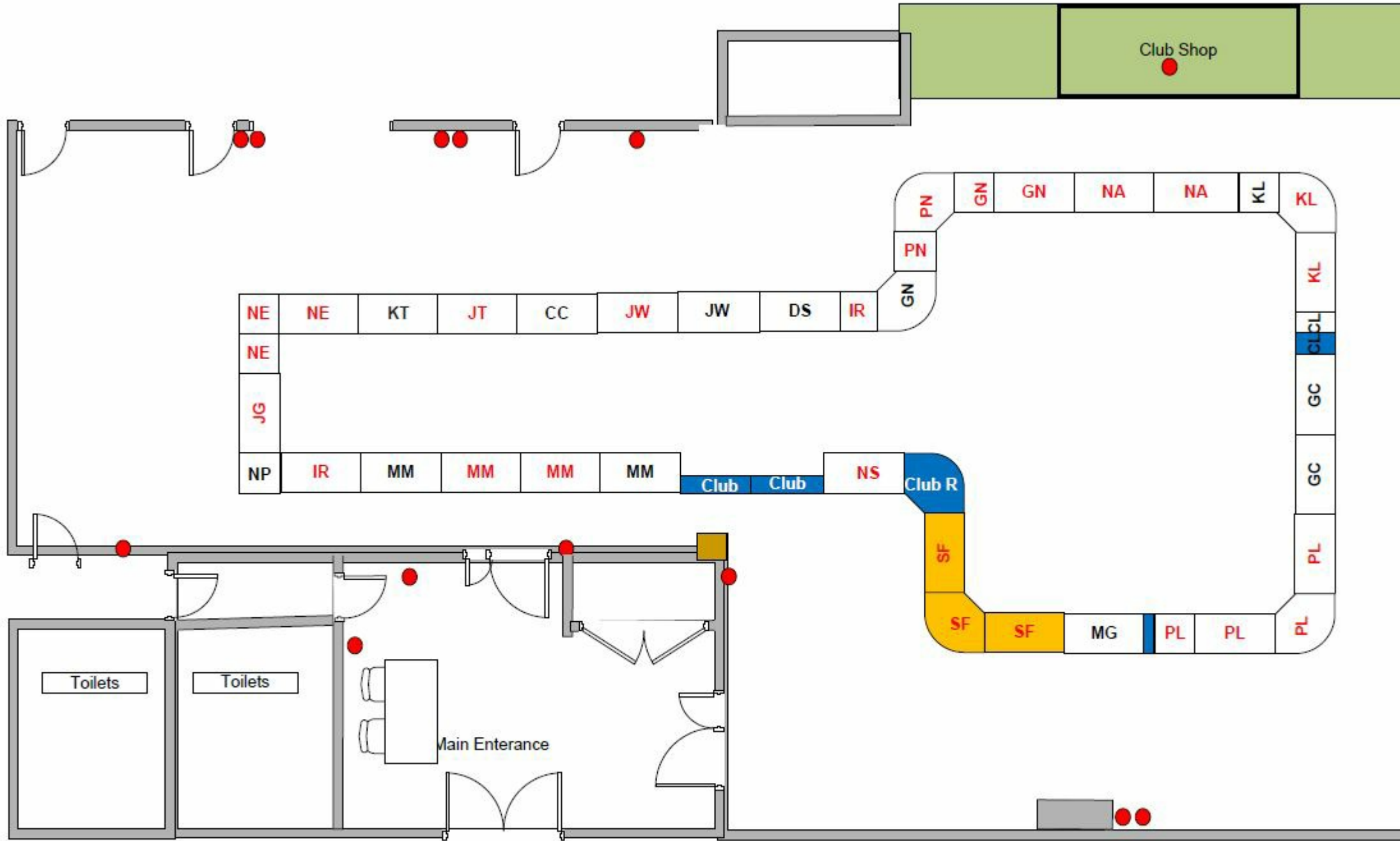

← 50 mtrs Material →